

Gate Lodge, Proposed Ground Floor Plans

\*All dimensions in millimeters.  
All levels (in meters) are related to Malin Head levelling datum.

Legend	Floor Areas (Proposed)	Material Key
Existing	<b>3 Bed, 4 Person House</b> Ground Floor Area = 128m <sup>2</sup> Existing = 50.5m <sup>2</sup> Proposed = 77.5m <sup>2</sup> Demolitions = 41.9m <sup>2</sup> Total Floor Area = 128m <sup>2</sup>	AD Aluminium clad door
Proposed		AW Aluminium clad window
Demolitions - Non Original Fabric		BA Brick screen to AW
Demolitions - Original Fabric		BR Brick finish
Removal and Relocation of Original Fabric		CB Concrete block finish
		GC Glazed balustrade
		MF Metal finish
		MR Metal roof finish
		RF Render finish
		SC Stone coping / sill
		SR Slate roof finish
		ST Stone finish
		TD Timber door
		TF Timber finish
		TR Terracotta ridge / hip tiles
		TW Timber window
		WP Waterproofing

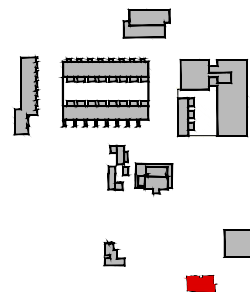

Revision Description	Date	Rev. No.	Issued by
LRD Stage 2 Submission	07-06-2024	C02	SK
LRD Stage 3 Submission	23-10-2024	C03	SK

Any reference to fire safety design or performance is presented for coordination purposes only. Refer only to the granted Fire Safety Certificate, and fire consultant's information for fire safety design, specification and performance.

Figured dimensions only to be used. This drawing is copyright of O'Mahony Pike Architects Ltd. All information is shared as per approved use in accordance with ISO19650-2:2018, Table 5; Standard Codes for Suitability of Models and Documents and the BEP. If the 'Status' field is empty, this information has been shared at 50 - WIP.

**mahony pike**

architecture | urban design  
 email: info@mahonypike.com  
 tel: +353 1 202 7400  
 fax: +353 1 283 0822  
 www.mahonypike.com

**Dublin**  
 The Chapel  
 Mount St. Anne's  
 Milltown, Dublin 6  
 Co. Cork

**Cork**  
 One South Mall  
 Cork City  
 Co. Cork  
 D06 XN52 Ireland  
 T12 CCN3 Ireland

Project Code: ---  
 Project Lead: SD  
 Drawn By: MW  
 Job No.: 1307G  
 Purpose: LRD Stage 3 Submission

Scale @ A3: 1:100  
 Date Printed: 23-10-2024  
 Current Rev.: C03  
 Status: A3

Project: Knockrabo Phase 2  
 Location: Mt. Anville Road, Dublin 14  
 Client: KIDAC

Drawing Title: Gate Lodge, Proposed Ground Floor Plans  
 Drawing No.: 1307G-OMP-GL-00-DR-A-1000